

Airflo 24 Stowage & Recharging Point - Operating Instructions

Models: CD0102-01/02

The Stowage and Recharging Point is connected to the vehicle 12v power supply. The 'Power On' light will show constant green when the vehicle's voltage is 12.5v and over. If the vehicle's voltage drops below 12.5v, the constant green light will turn to flashing orange.

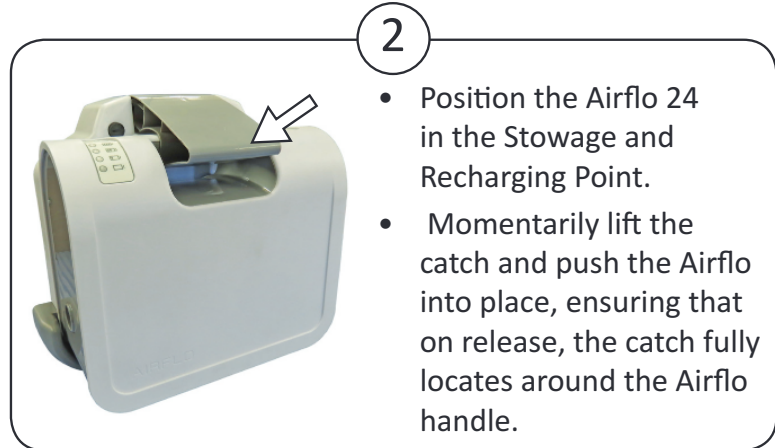
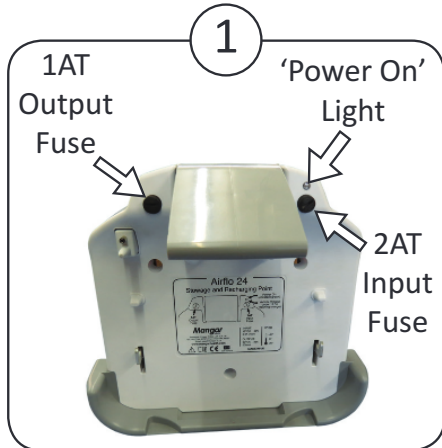

When the Airflo 24 is mounted, it automatically begins to recharge.

WARNING: If the battery status indicator lights on the Airflo do not light up, check that the Airflo is fully located on the Recharging Point and that the handle is fully located around the Airflo handle.

When the battery is being charged:

- For the first 3 hours, the bottom light will flash green. After 3 hours the first light will become a steady green and the second light will start flashing. After 6 hours the bottom 2 lights will remain green and the third light will flash. After 9 hours the bottom 3 will remain green and the top will be flashing. Then after 12 hours all lights will become steady green.
- After 5 minutes the compressor will move into an energy saving mode with the top LED flashing every 6 seconds and the other 3 will be off.

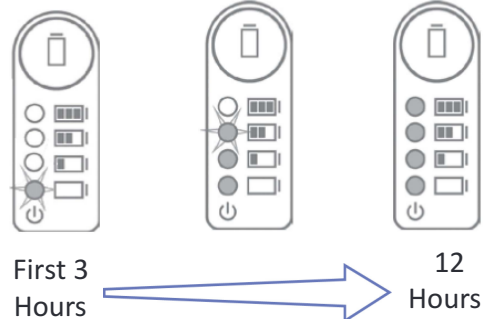
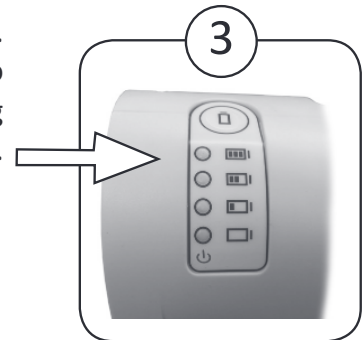

NOTE: In the case of a power cut, switching the power socket off or disconnecting the charging lead the charging process will not be interrupted as the unit remembers the previous charge state.

Mangar International Ltd, trading as Mangar Health, reserves the right to alter product specifications and/or any of the information contained within this document without notice.

Mangar International

Prestegne, Powys
Wales, UK, LD8 2UF

tel: +44 (0)1544 267674

fax: +44 (0)1544 260287

sales@mangarhealth.com

www.mangarhealth.com



MI0356 issue 4

Mangar
HEALTH